

- KD 501 -series secondary connectors for two-core cable (plug)**
- KD 502 -series secondary connectors for two-core cable (receptacle)**
- KD 503 -series secondary connectors for two single wires (plug)**
- KD 503/R -series secondary connectors for two single wires (receptacle)**

Read these instructions before installation

Caution

Only personnel qualifying to work with high voltage equipment and circuits are allowed to do the installation. Make sure that the circuits are disconnected from the voltage supply and correctly grounded. Never connect or disconnect live circuits. Voltage of primary circuit is lethal. Make sure that the outer diameter of cable and the diameter of cable insulation correspond to the connector type. Check also that any damage has not occurred for the connectors otherwise do not proceed with the installation.

Follow the local instructions for safety precautions or refer to the FAA advisory circular AC150/5340-26 (maintenance of Airport visual Aid Facilities). Follow also Advisory circular AC150/5370-10 part XI Lighting installations. Always test the installation according to above mentioned documents and local instructions.

Make sure that dimensions of the cable comply with type of connector used. In case of any kind of non-compliance do not proceed with the installation.

Secondary connectors for two-core cable			
Plug	Receptacle	Conductor size	Cable diameter
KD501	KD502	1.5 - 2.5 sqmm	8.5 - 13.5 mm
KD501.1	KD502.1	4.0 - 6.0 sqmm	11.5 - 18.0 mm
KD501.2	KD502.2	4.0 - 6.0 sqmm	8.5 - 13.5 mm
Secondary connectors for two single wires			
KD503	KD503/R	1.5 - 2.5 sqmm	2.8 - 4.0 mm
KD503.1	KD503.1/R	4.0 - 6.0 sqmm	3.8 - 5.5 mm
KD503.2	KD503.2/R	4.0 - 6.0 sqmm	2.8 - 4.0 mm

Each package contains:

- 1 Silicone grease tube
- 1 Body with connecting parts
- 1 Plug or receptacle housings
- Cleaning cloth
- Installation instructions

Example KD501.2 Conductor size 4.0 - 6.0 sqmm, cable diameter 8.5 - 13.5mm.

- Step 1)** Clean approx. 20cm of the cable end with a cleanser, i.e. spirit or equivalent and let dry.
- Step 2)** It is recommended to remove sharp edge of the cable insulation especially when the cable diameter is in the upper half of the cable diameter range.
- Step 3)** Open the front of silicon grease tube and dip the cable end in the silicone grease. Push the cable through the housing before the stripping of wires.

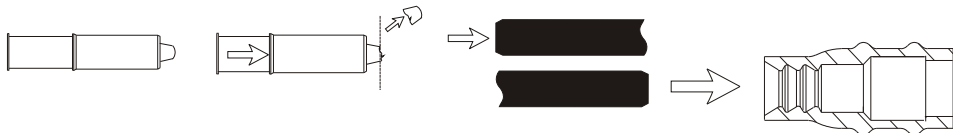

Step 4) Clean the cable end again with cleanser, i.e. spirit or equivalent

Step 5) Strip the sheath of a two core cable 20 ±5 mm for plugs (KD 501-series), but only 13 ±5mm for receptacles (KD 502-series). Wires should be stripped up to 8 ±1 mm.

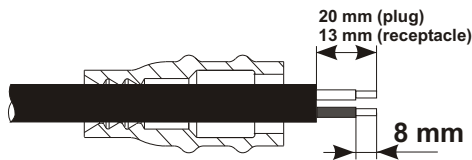

Step 6) The insulation of single core cables (wires) should be stripped up to 8 ±1 mm (KD 503 and KD503/R-series).

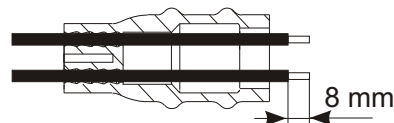

Crimping tools suggestions for secondary connector kits, others trademarks may be used if the installer verifies adequate crimping.	Conductor size: 1.5 - 2.5 mm²	Conductor size: 4 - 6 mm²
	ELPRESS DKB 0760	ELPRESS EWB 4099C

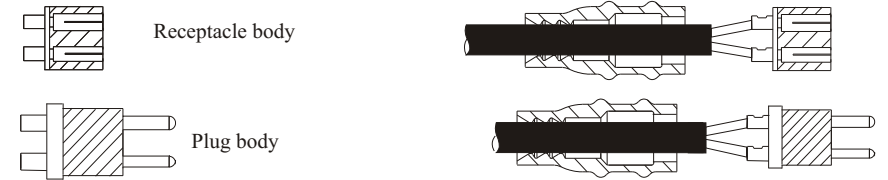

- Step 8)** Grease the body with silicone grease tube.
- Note:** Piston must be pushed to the end for maximising the silicon grease volume inside of the housing.

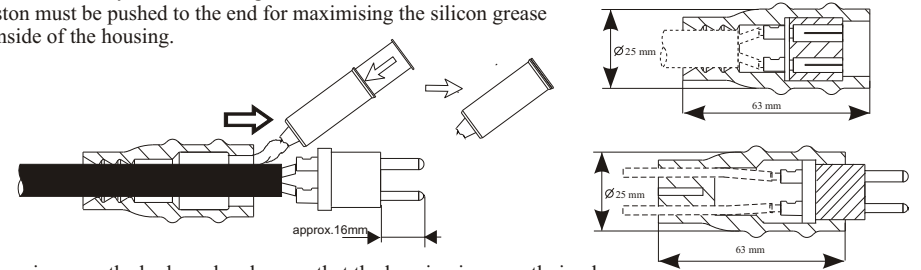

Pull the housing over the body and make sure that the housing is correctly in place.

If the PMR 755 sealing unit is used with a receptacle, grease lightly the inner surface of the ring with silicon grease and push it over the housing.

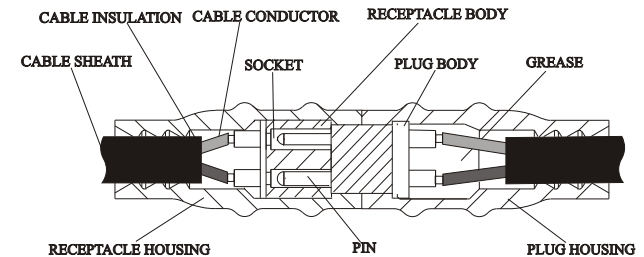
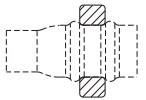

Additional tape securing

After the connectors are plugged together make sure that the outer surface of connectors are clean and dry. Otherwise clean the outer surface of the connectors between male and female connectors min. 40 mm (1,5 inch) with aliphatic solvents (Spirit or equivalent). Wrap the joint where the connectors come together with at least one layer self-vulcanizing rubber tape (Scotch 23 or 130C) so that one half-lapped extends at least 20mm (0,8 inch) of each side of joint. Wrap at least one layer of PVC electrical tape (Scotch Super 33+ or equivalent) over the rubber tape.

Disconnection:

Remove possible tape from the joint of male and female. Pull the connector apart without bending.

Liability for defects

This product will perform within the recommended operational ratings when installed and operated in accordance with these instructions. EFLA Oy liability is limited to replacement of component parts designed and manufactured by EFLA OY which are proved to be defective in design, workmanship or material. For further details see our conditions of sale NL 92E.